

LAS1-AGQ Series

Part-number Description >>

LAS1 — ★ — □ ■ ◆ ◇ / ◆ ● / △ / ▲							
Code of Series	Code name AGQ AGQ30	Contact structure 11 1NO1NC 22 2NO2NC	Operation mode Z Latching type X Selector type Y Key-lock type M Buzzer SM Flash buzzer No letter means momentary	Lamp type D Dot E Ring	◆ Operation position of selector and key-lock type: 2 Two position 3 Three position  ● Operation type of selector and key-lock switch: 1 Maintain 3 Return	Lamp color R Red G Green Y Yellow O Orange B Blue W White	Lamp and buzzer's voltage AC/DC 6V AC/DC 12V AC/DC 24V AC/DC 110V AC/DC 220V  Note: Other voltage can be made to order

Note: Pls read the catalog carefully ,and choose the right part - number according to the sign.

Lamp Ratings >>

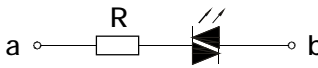
Lamp Type	LED lamp(AC/DC)			Lamp Circuit Diagram	<div></div> <p>Using AC/DC LED lamp, the terminals have no difference of anode and cathode: Using inner resistance, do not need connect outer resistance.</p>
Rated Voltage	AC/DC6V	AC/DC12V	AC/DC110V		
	AC/DC24V	AC/DC36V	AC/DC220V		
Rated Current	About 15mA		About 3mA		
LED Color	<div><div>R</div><div>G</div><div>Y</div><div>O</div><div>B</div><div>W</div></div>				
Life	40000 hours(Reference)				

Note: DC LED and other voltage can be made to order.

Switching Operation >>

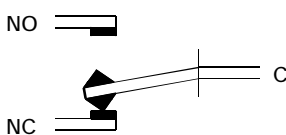
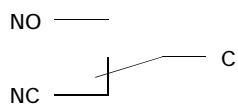
Type	C
Diagram	
Sign	
Explanation	Using three terminals, single-break and fast-motion changeover contact.

Terminal Description >>

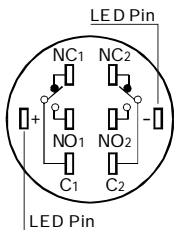

- Can use at most two sets.
- C1,NO1,NC1 and C2,NO2,NC2 are one set respectively;
- C is common used, NO is normal opened, NC is normal closed;
- +, - are lamp terminals, the standard LED have no difference of anode and cathode.
- The lamp and switch are relatively independent and can use switch or peripheral circuit to control the lamp state.

Installation Effect >>

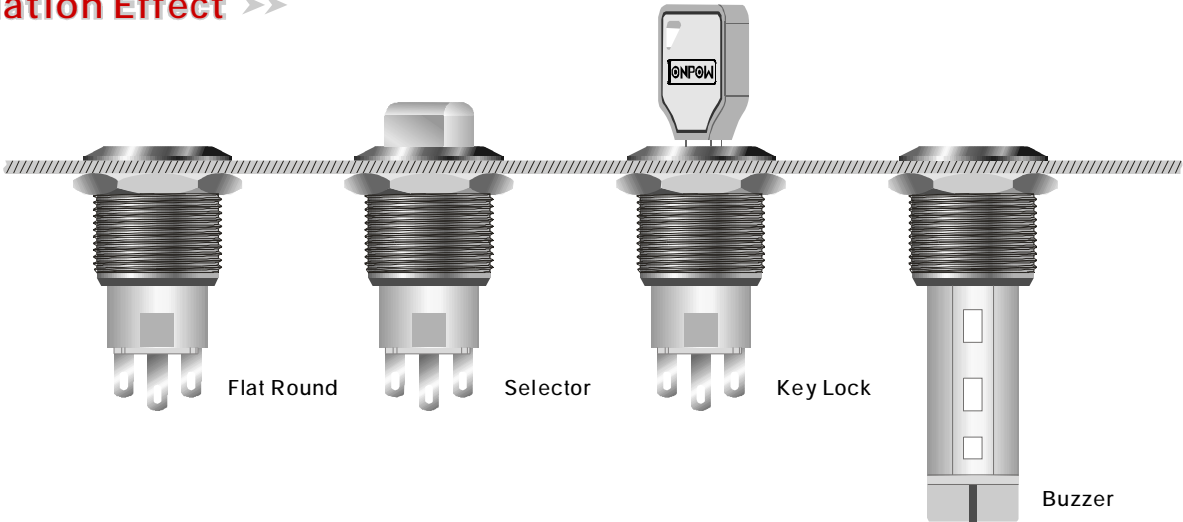

## Metal (illuminated) selector switch



- Φ 19mm Diameter
- Switch Rating: 5A/250VAC
- Contact Configuration: 1NO1NC/2NO2NC
- Operation Position: Two Position/ Three Position
- Operation Type: Maintain/Return
- The Crust Material: Stainless Steel
- Arrowhead Illuminated
- IP Degree: IP67, IK02

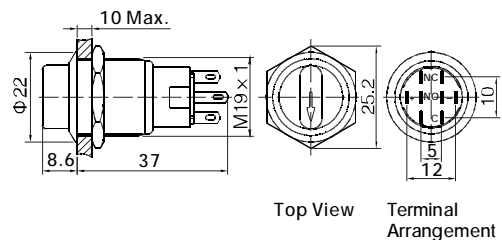

## Metal key lock switch



- Φ 19mm Diameter
- Switch Rating: 5A/250VAC
- Contact Configuration: 1NO1NC / 2NO2NC
- Two Position Maintain/ Two Position Return
- Three Position Maintain
- The Crust Material: Stainless Steel
- IP Degree: IP65, IK02

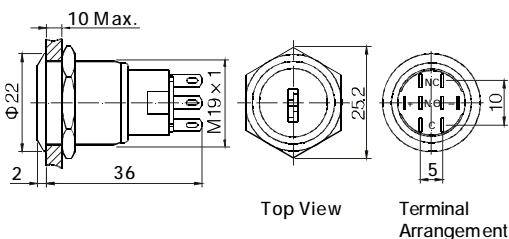

Specification		LAS1-AGQ-□X/◆●/△/▲	LAS1-AGQ-□Y/◆●		
The Front Shape		Selector	Key Lock		
Terminal Type		Pin Terminal(2.8×0.5mm)	Pin Terminal(2.8×0.5mm)		
Switching		C(single-break fast-motion changeover contact)	C(single-break fast-motion changeover contact)		
Max. Switch Rating		Ith:5A Ui:250VAC	Ith:5A Ui:250VAC		
Contact Resistance		≤50mΩ	≤50mΩ		
Insulation Resistance		≥1000MΩ	≥1000MΩ		
Dielectric Intensity		2000VAC	2000VAC		
Operating Temp		-20℃ ~ +55℃	-20℃ ~ +55℃		
Mechanical Life		500,000 cycles	500,000 cycles		
Electrical Life		50,000 cycles	50,000 cycles		
Panel Thickness		1 ~ 10mm	1 ~ 10mm		
Torque		5 ~ 14Nm	5 ~ 14Nm		
IP Degree		IP67,IK02	IP65,IK02		
Material	Contact	Silver Alloy	Silver Alloy		
	Button	Stainless Steel	Stainless Steel		
	Body	Stainless Steel	Stainless Steel		
	Base	PBT	PBT		
	RoHS	Made to order	Made to order		
LED Spec.	Type	Arrowhead(LED)	——		
	Rated Voltage	6V / 12V / 24V / 110V / 220V	——		
	Color	<div><div>R</div><div>G</div><div>Y</div><div>O</div><div>B</div><div>W</div></div>	——		
	Life	40000 hours	——		
LAS1-AGQ State chart in operation	Position	Contact	Left	Center	Right
	90° Two position	1NO1NC			
		2NO2NC			
	45° Three position	2NO2NC			