

Features

- Trip-free.
- Standard rating : 4 to 16 amp AC 125V & 250V, 32VDC (UL, CUL) or welcome customer design.
- Provides circuit protection and power switching in a single unit.

Typical Applications

Motors, Transformers, Household and office machines, Instrumentation, Surge protectors, Power centers.

International Patent

TAIWAN. CHINA. USA. JAPAN. KOREA. GERMANY.

Safety Approvals



Technical Data

Electrical Data @25°C

Calibration:

Will continuously carry 100% of rating, must trip at 150% of rating within one hour at + 25°C.

Dielectric Strength:

Withstands 1500VAC at 60Hz/50Hz for 60 seconds. Between all electrically isolated terminals.

Insulation Resistance:

Not less than 100 megohms at 500VDC.

Maximum Operating voltages:

125 or 250VAC, 50/60 Hz. (model dependent)

Endurance:

6,000 operations at a rate of 6 operations per minute. (full rated current)

Ambient operation:

Operates normally in temperatures between 0°C to + 65°C.

Ordering Information

PF L S A F 01 R 1 - 02

↑	↑	↑	↑	↑	↑	↑	↑
Customer Number	Actuator Color Category	1 : Red #1	Actuator Color Option	R : Red Translucent	Actuator Style	01 : Type #1	Current Rating
F : 15 Amp	Voltage & Thickness of Ag	A : AC 125V 0.2mm	C : AC 250V 0.2mm	Terminal Style Option	S : Short	L : Long	Lamp Option
L : With Lamp	N : Without Lamp	Product Code	PF : SS-006				



Outline Dimensions

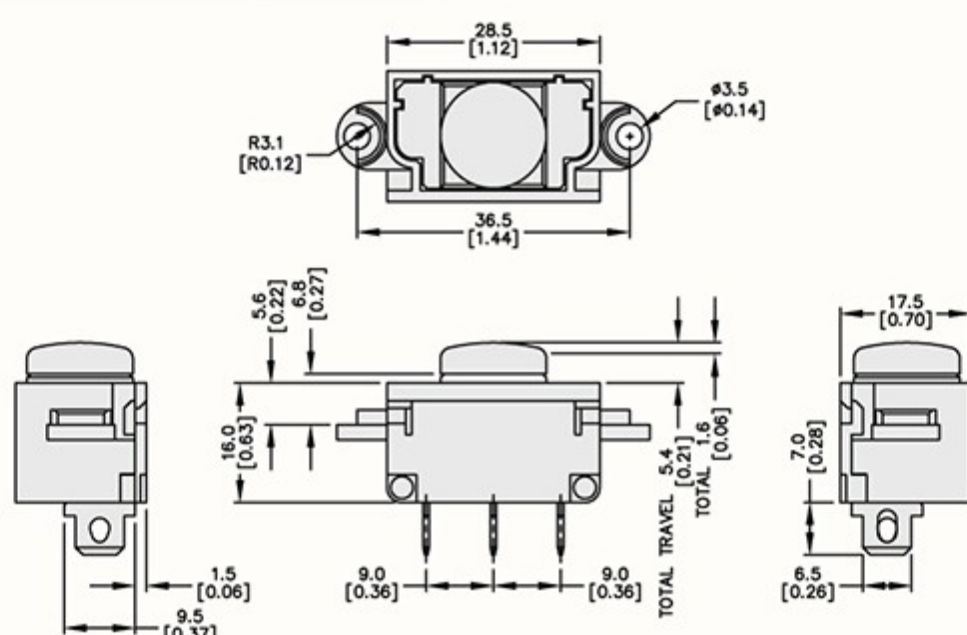

Internal Connection Diagram

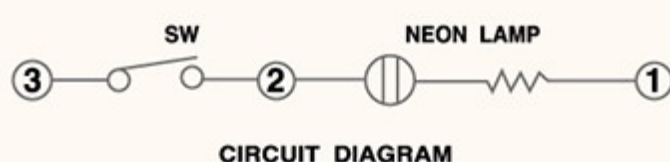

Time VS. Current Trip Curve @+25°C

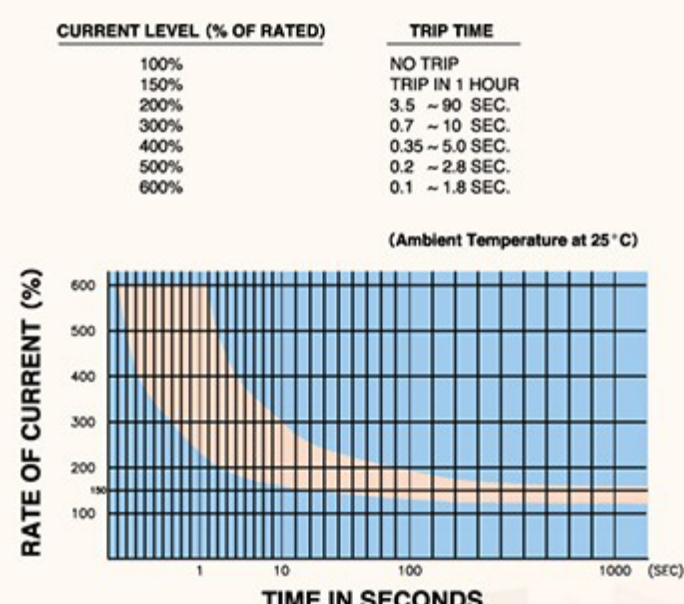

Ambient Compensation Table

Ambient Temperature in °C	Rating Correction Factor
	4A~16A Models
0	X2.4
10	X1.5
20	X1.05
25	X1
30	X0.95
40	X0.8
50	X0.65
65	X0.45